

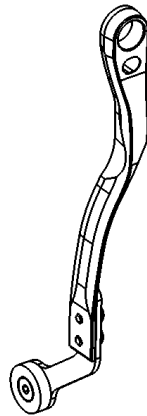

K-EDGE SRM Pro Road Chain Catcher

Installation Instructions
(K13-602)



K13-602

Description:

The K-EDGE SRM Pro Road Chain Catcher series is designed with the same 'tried-and-true' functionality of the K13-002 with the addition of a cadence magnet for direct compatibility with SRM PowerMeters.

Compatibility:

The K13-602 SRM Pro Road Chain Catcher series is designed to fit braze-on front derailleur mounts (i.e. hard mounted to the frame with the vertical adjustable slot and front radius) only with a double chainring crankset.

Some frames with a hard mounted braze-on and vertical slot may have a 'flat' front face where a radius should be, this type of mount will NOT work with the mounting system of this chain catcher. If you do have this type of frame please contact K-EDGE Support for a possible solution/adapter.

Some braze-on clamp adapters may not be compatible with the mounting system of this chain catcher, a K-EDGE Braze-On Clamp adapter will be released in the near future to accommodate the new mounting system. If you need a braze-on mount adapter contact either your local bike shop for a solution or K-EDGE Support for availability.

The K13-602 SRM Pro Road Chain Catcher series is currently NOT compatible with Campagnolo EPS Front derailleurs at this time. An adapter will be released in the near future.

WARNING: IT IS STRONGLY RECOMMENDED THAT YOU PERIODICALLY CHECK ALL BOLTS FOR PROPER TORQUE!!!

Warnings:

All K-EDGE products are to be installed by a professional bike mechanic.

These instructions are generalized to accommodate a wide ranges of setups for a bike. If your setup does not match what is being described, take extra care in the process of your setup and contact K-EDGE Support if you have any questions pertaining to this installation.

Improper installation of any K-EDGE product or use outside of its design intentions could lead not only to damaging the bike but could also cause personal injury to the rider.

Parts Included:

- K13-602:
 - ✓ 1x K-EDGE SRM Pro Chain Catcher
 - ✓ 1x M5 x 20mm stainless steel cone head SHCS (For Campagnolo (except EPS) and SRAM)
 - ✓ 1x M5 x 17mm stainless steel cone head SHCS for (For Shimano)
 - ✓ 1x M4 x 9.5mm stainless steel cone head SHCS with thread-lock pre-applied
 - ✓ 1x Pro Radius washer
 - ✓ 2x M3 x 5mm stainless steel BHCS with thread-lock pre-applied
 - ✓ 1x M3 x 5mm stainless steel FHCS with RED thread-lock pre-applied
 - ✓ 1x Neodymium Magnet with countersunk hole
 - ✓ 1x K-EDGE Magnet Arm

Important Notes:

- ! The 2x M3 x 5mm BHCS holding the Magnet Arm DO NOT COME PRE-TORQUED, this will be done on Step #8 of the installation process.
- ! Periodically check the integrity of the cadence magnet, replace if cracked or chipped.

Tools/Items Required:

- ✓ Metric Allen Set (2mm, 3mm, and 4mm for mounting/locking bolts)
- ✓ Torque wrench

WARNING: IT IS STRONGLY RECOMMENDED THAT YOU PERIODICALLY CHECK ALL BOLTS FOR PROPER TORQUE!!!

Chain Catcher Installation Steps:

1. Position the CHAIN onto the SMALLEST CHAINRING on the crankset and the LARGEST COG on the cassette.
2. Thread the appropriate M5 MOUNTING BOLT through the PRO RADIUS WASHER and BRAZE-ON MOUNT and into the FRONT DERAILLEUR, adjust and tighten according to the manufacturer's recommendations. See Image below:

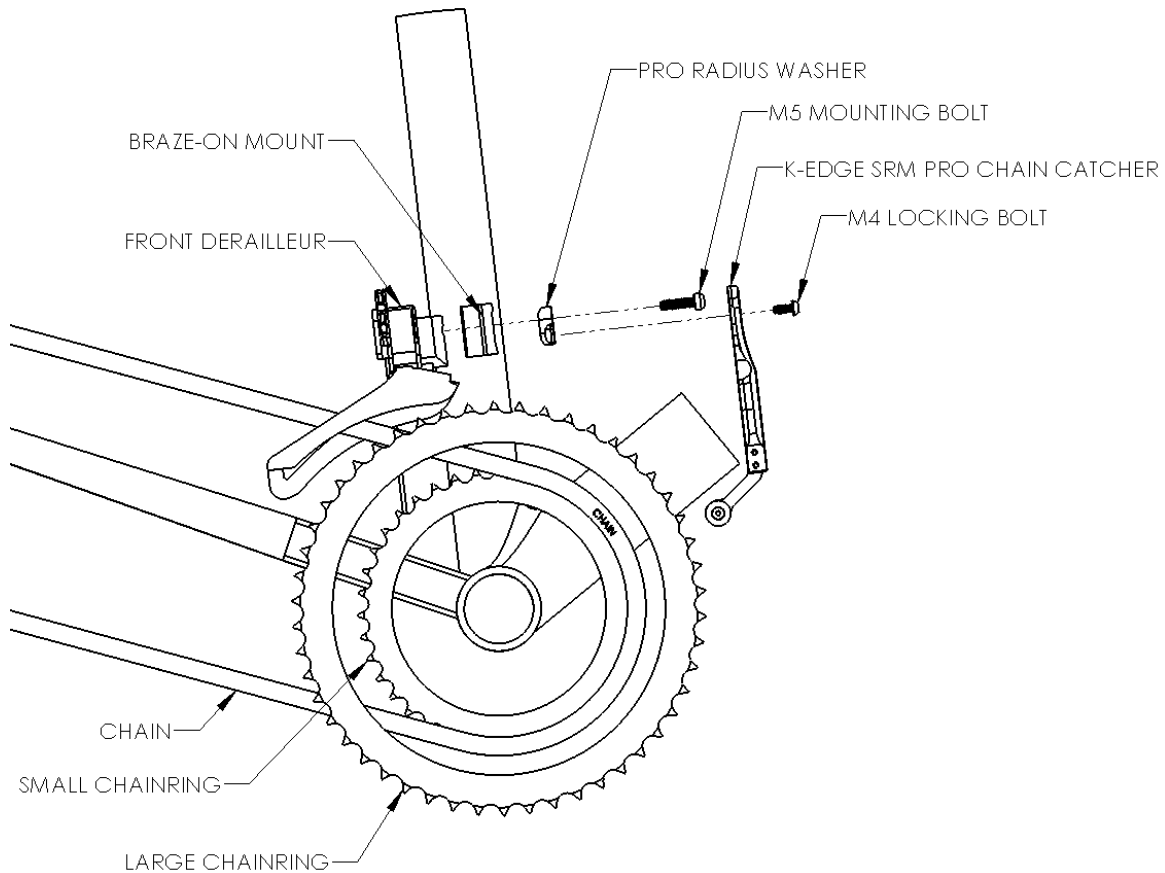

WARNING: IT IS STRONGLY RECOMMENDED THAT YOU PERIODICALLY CHECK ALL BOLTS FOR PROPER TORQUE!!!

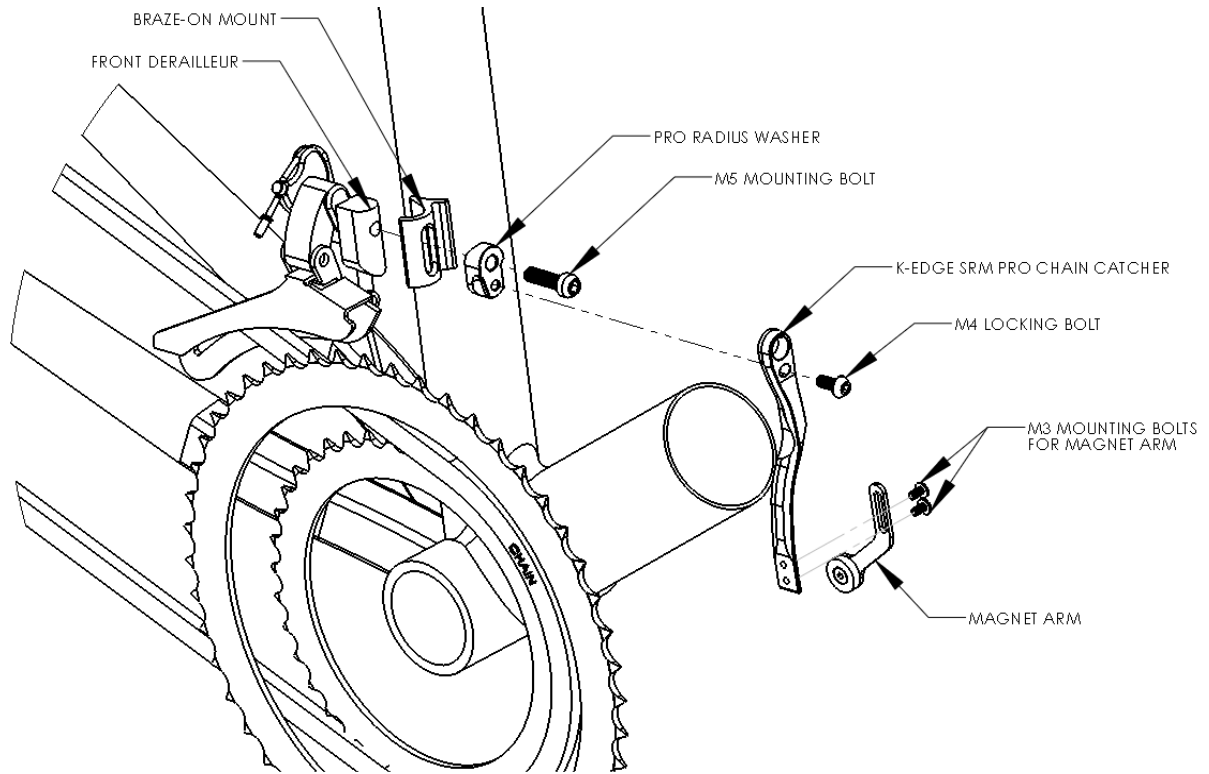

3. Slide the K-EDGE SRM PRO CHAIN CATCHER over the installed M5 MOUNTING BOLT.
4. Check and ensure that the position of the magnet is within the area shown in green in the diagram below.

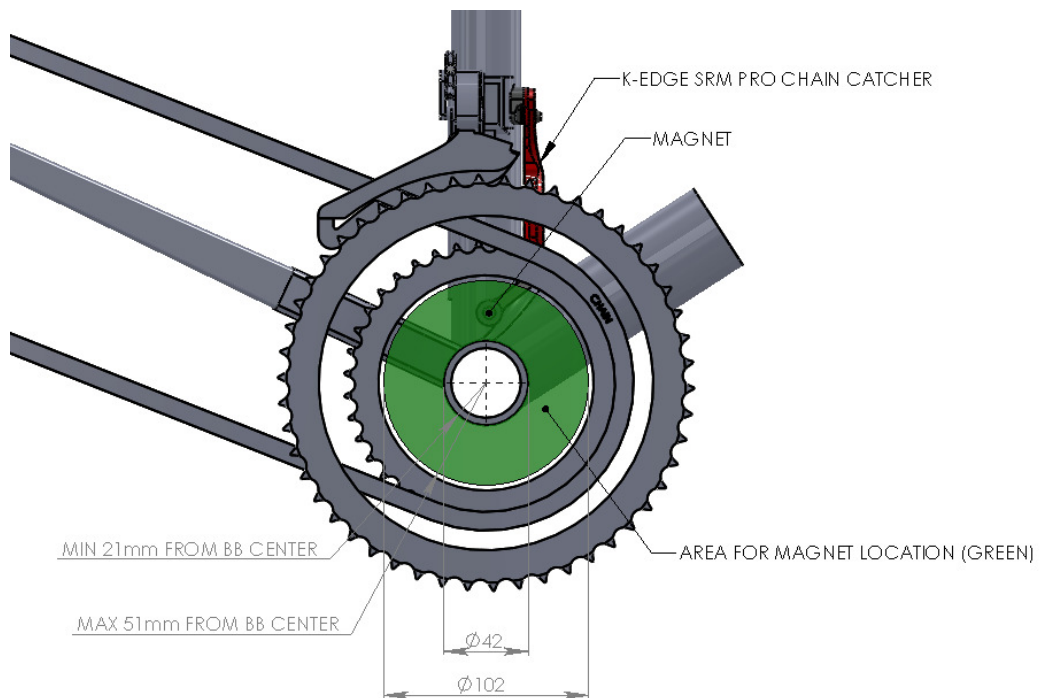

WARNING: IT IS STRONGLY RECOMMENDED THAT YOU PERIODICALLY CHECK ALL BOLTS FOR PROPER TORQUE!!!

5. Adjust the position of the MAGNET ARM as necessary by removing the K-EDGE SRM PRO CHAIN CATCHER and adjusting the MAGNET ARM by the 2x M3 MOUNTING BOLTS and reinstalling back onto the M5 MOUNTING BOLT.
6. Check and ensure there is clearance between the MAGNET ARM and the FRAME, in very few cases and depending on frame design, slight bending of the magnet arm may be necessary.

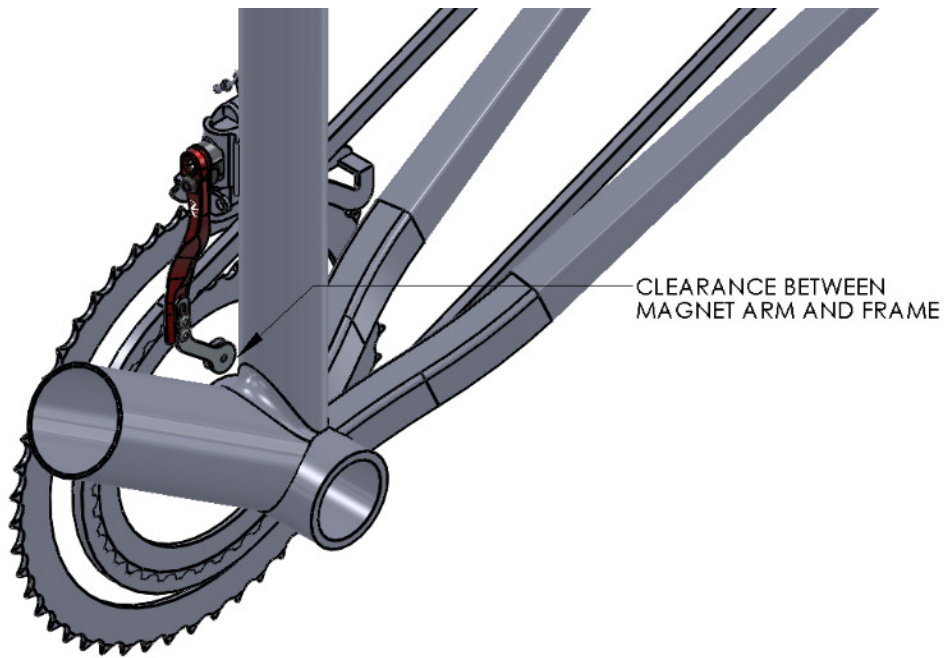

7. Check and ensure there is clearance between the MAGNET ARM and the BACKSIDE OF THE POWERMETER.
8. Carefully torque the 2x M3 MOUNTING BOLTS using a 2mm Allen socket to **2-3N-m**. Recheck for clearance between the FRAME, MAGNET ARM, and POWERMETER.
9. Install the M4 LOCKING BOLT through the K-EDGE SRM PRO CHAIN CATCHER and into the PRO RADIUS WASHER, lightly tighten bolt allowing for adjustment and sensor check.
10. Position the K-EDGE SRM PRO CHAIN CATCHER as close to the CHAIN as possible without contacting (Approximately 0.5mm). See image below:
11. Check for clearance between the chainring bolts and the K-EDGE SRM PRO CHAIN CATCHER. (Some chainring bolts protrude further than others.)

WARNING: IT IS STRONGLY RECOMMENDED THAT YOU PERIODICALLY CHECK ALL BOLTS FOR PROPER TORQUE!!!

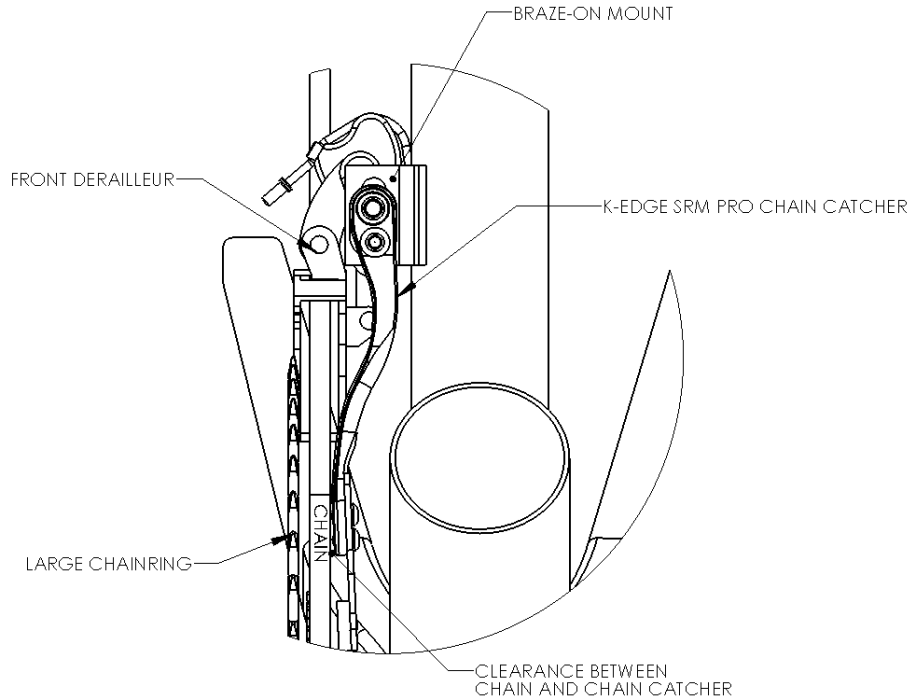

12. Confirm proper positioning of the magnet by referring to the SRM User's Guide for pairing instructions:

- IF PAIRING IS SUCCESSFUL – Proceed to Step #11
- IF PAIRING IS NOT SUCCESSFUL – Repeat Steps #3 - #10

13. Ensure contact of the M5 MOUNTING BOLT is tangent to the right side of the hole that it is in on the K-EDGE SRM PRO CHAIN CATCHER. See image below:

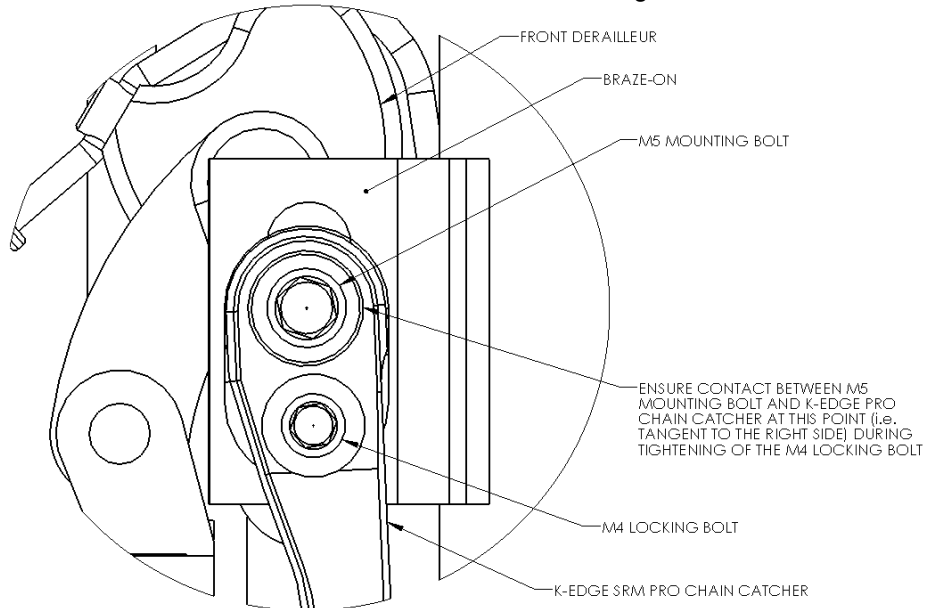

14. Carefully torque the M4 LOCKING BOLT using a 3mm Allen socket to **3-4N-m**. Recheck for clearance between CHAIN and K-EDGE SRM PRO CHAIN CATCHER.

WARNING: IT IS STRONGLY RECOMMENDED THAT YOU PERIODICALLY CHECK ALL BOLTS FOR PROPER TORQUE!!!

Troubleshooting:

- Chain drops even though chain catcher is installed.
 - Check the chain catcher for proper adjustment. (Refer to Steps 11-14)
 - Check and ensure the chain catcher is approximately 0.5mm distance away from the chain itself. (Refer to Step 11)
 - Adjust the torque of the M4 MOUNTING BOLT so that it is not loose and is not allowing the chain to push the chain catcher inward towards the frame. (Refer to Steps 11-14)
- There is a “clicking” sound while riding.
 - Check the chain catcher to ensure it isn’t adjusted too close to the chainring bolts, but still close enough to catch the chain if it were to drop. (Refer to Step 12)
 - Check the position of the magnet and ensure it is not in contact with the backside of the PowerMeter (Step 7).
- Chain is rubbing on the chain catcher and cannot be further adjusted.
 - Ensure installation is correct. (Repeat Steps 11-14)
 - If problems persist contact K-EDGE Support as your frame design may be interfering with the chain catcher.
- Chain is rubbing on the derailleur after installation of the chain catcher.
 - Check the adjustments of the front derailleur so that it’s in accordance with manufacturer’s recommendations. (Refer to Step 2)
 - Check the height of the front derailleur in conjunction with the chain to ensure there isn’t contact between the chain and front derailleur cage.
 - If problems persist contact K-EDGE Support.
- Chain catcher isn’t adjustable.
 - Ensure that the M4 LOCKING BOLT is not too tight for adjustment. (Refer to Step 9)
- Cadence is not being detected on the SRM PowerControl.
 - Confirm Step 12 is completed.

Support/Contact:

If problem(s) still persist after troubleshooting, please contact K-EDGE Support for further assistance at info@K-EDGE.com immediately. Please be sure to include your full name, phone number, K-EDGE product purchased, brand and model of bike, crankset with ring sizes, front derailleur, cassette size (if applicable), rear derailleur (if applicable) and a brief description of your problem.

If you cannot pair or get cadence from your SRM PowerMeter after confirming magnet position, contact the SRM office in your area:

SRM USA: (P) 719-266-4127 (E) usa@srm.de

SRM Germany: (P) +49 2461 69123 0

SRM Italia: (P) +39 0583 332036

SRM Oceania: (P) +64 (3) 355 9467

www.srm.de/contact/

WARNING: IT IS STRONGLY RECOMMENDED THAT YOU PERIODICALLY CHECK ALL BOLTS FOR PROPER TORQUE!!!